

HSF

TECHNICAL SPECS:

Current Rating:1.0AMP
 Contact Resistance:10mΩ Max
 Dielectric Strength: Min 500VRMS
 Mechanical Life: Min 500 cycles
 Mating Pin:∅0.38 to ∅0.50mm
 Forces: (polished steel gauge ∅0.41mm)
 Insertion:150g Max/Pin, Withdrawal:30g Min/Pin
 Operation Temperature:-40°C to +105°C

Sleeve:Brass CuZn36Pb3(C36000),Sn over Ni
 Contact Clip(6 finger):BeCu(C17200),Au or Sn over Ni
 Insulator Material:PPS+30%G.F(UL94V-0)

Ordering Information

3524-382 XX R XX 089 X 1

No. of Pin 2~50PIN	Contact Plating S0=Gold Flash/Tin S3=10u"Gold/Tin S4=15u"Gold/Tin S5=30u"Gold/Tin SN=Tin	Packing A=Tray T=Tube
-----------------------	---	-----------------------------

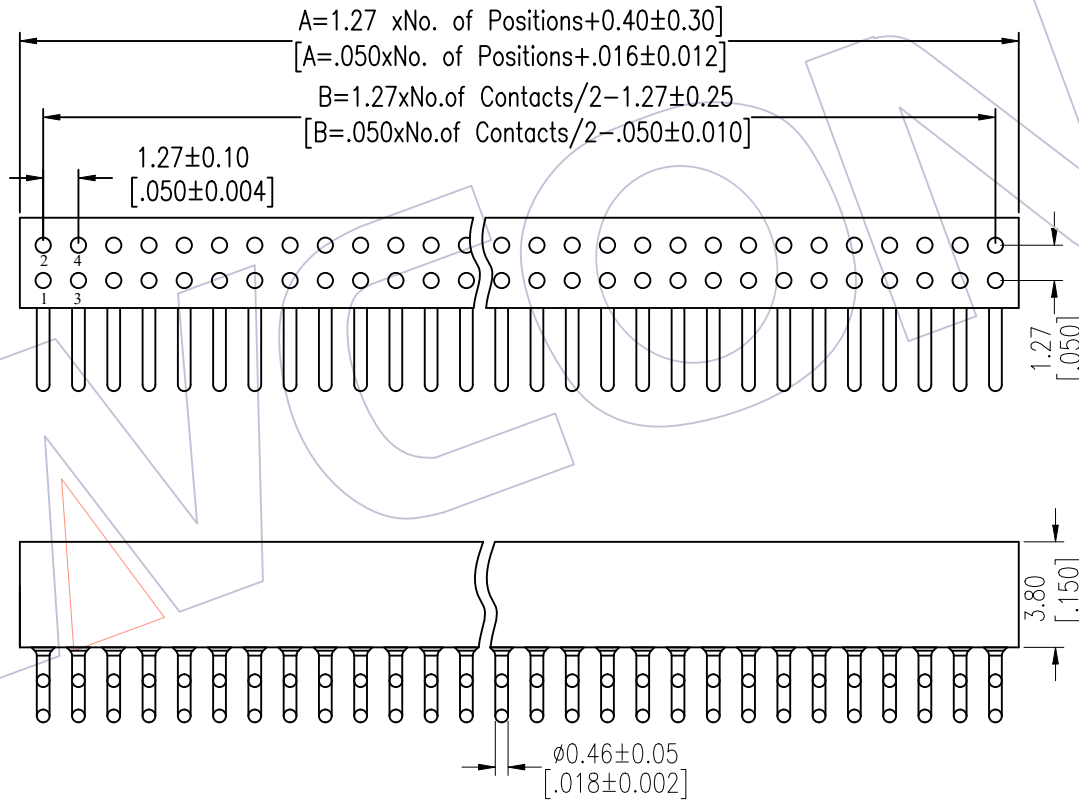

Recommended P.C.B Layout(Top Side)
 (PCB BOARD TOLERANCE ±0.05)

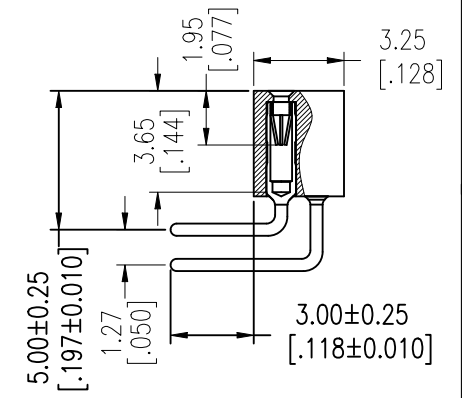
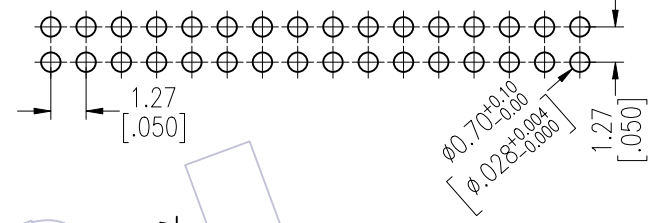

Item	Pitch	Mating
Standard	1.27	3514
Alternate		

REV	DATE	MODIFICATION DESCRIPTION	CHANGE	OPERATION	DRAW	DATE	SCALE	FIT	PART NO.
A1	2013/01/15	Modify drawing		x.x ±0.40	wang	2013/01/15	UNIT mm		3524-382XXRXX089X1
A0	2012/10/16	NEW	-----	x.xx ±0.25	CHECK	DATE	SIZE A4		TITLE: 1.27mm MACHINED FEMALE HEADER DUAL ROW 90° H=3.80
				x.xxx ±0.15	APPROVE	DATE	SHEET 1/1		Customer NO.
				Angle ± 3'			PROJ.		
				DIM TOL					

WCON
 Http: www.wcon.com

WCON-Dongguan	WCON-Kunshan
Tel: +86 769 85358920	Tel: +86 512 57468408
Fax: +86 769 85358915	Fax: +86 512 57468468
E-mail: sales@wcon.com	E-mail: salesks@wcon.com